

TRANSFORMERS UNIVERSE

AGES 5+
B3840/B3793 ASST.



NOTE: Some parts are made to detach if excessive force is applied and are designed to be reattached if separation occurs. Adult supervision may be necessary for younger children.

CHANGING TO VEHICLE

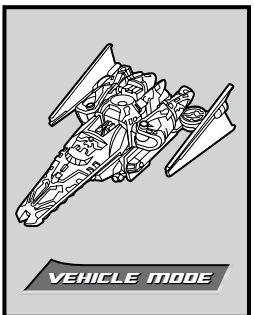
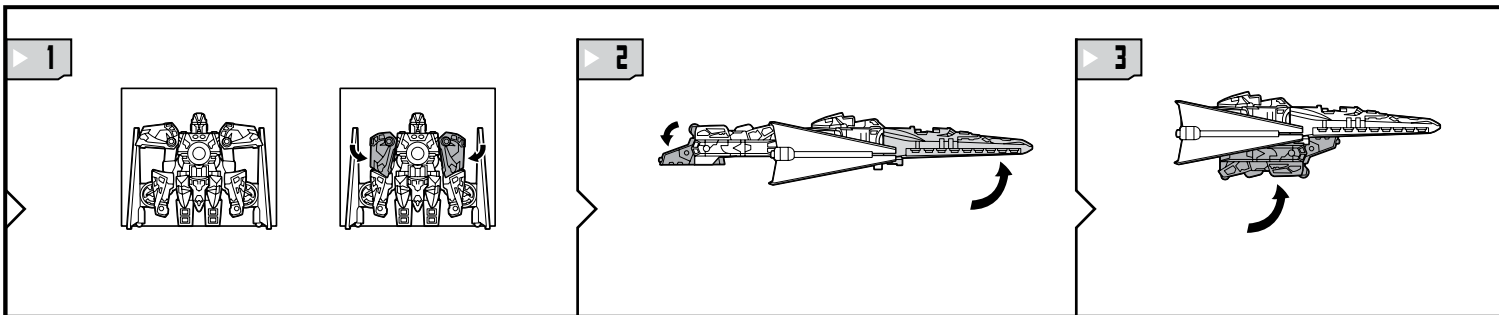
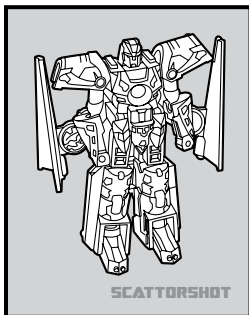
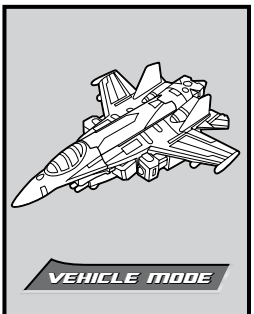
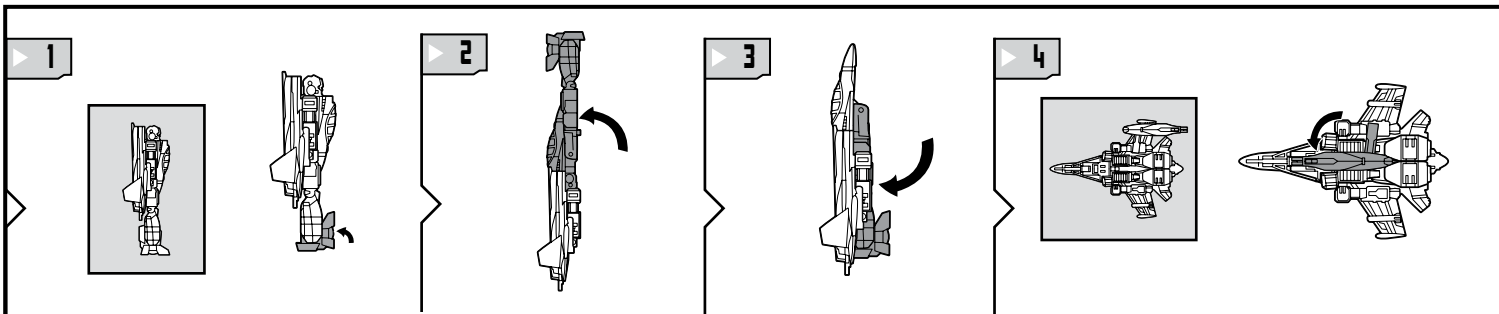
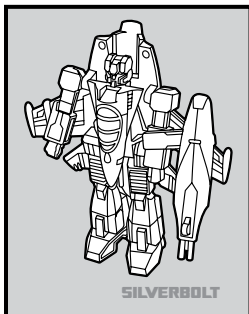
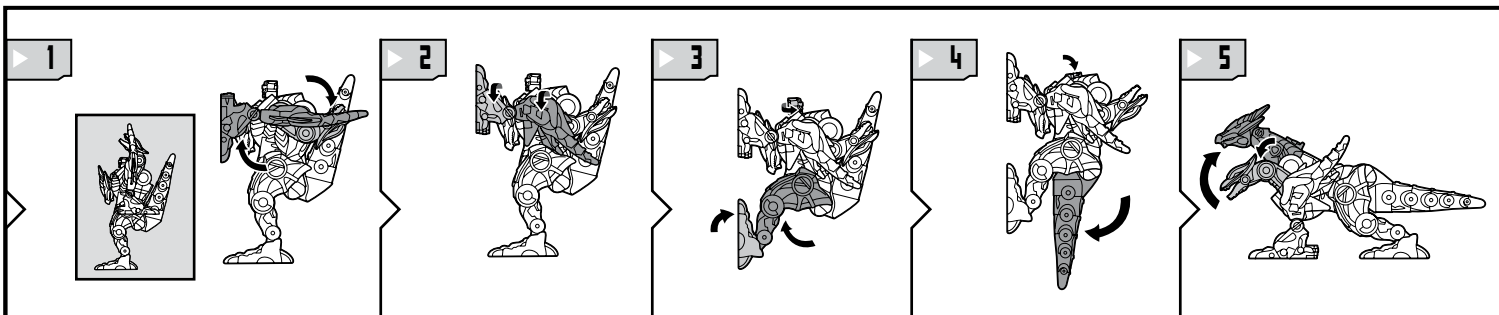
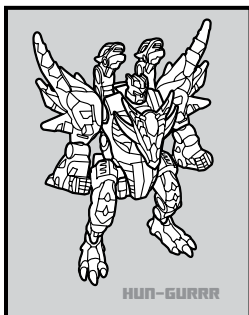
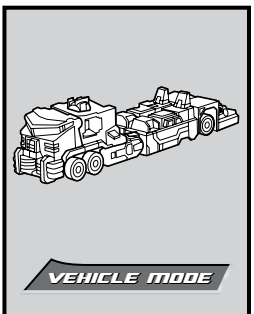
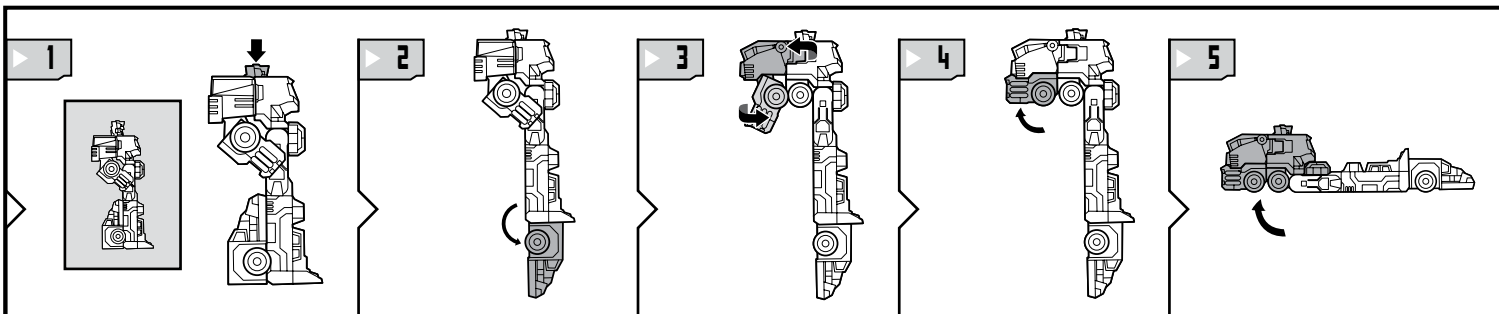
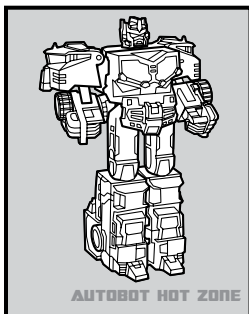
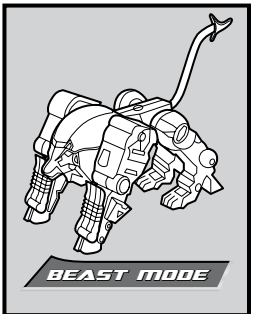
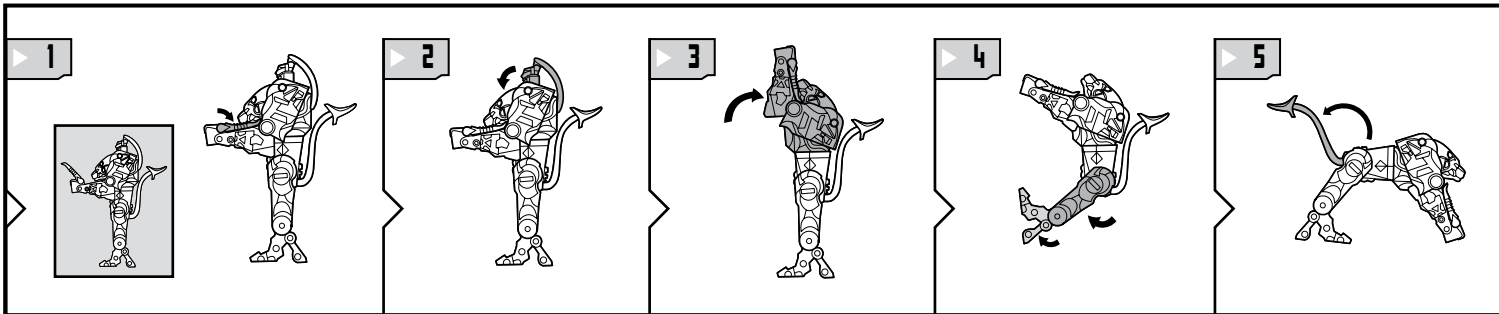
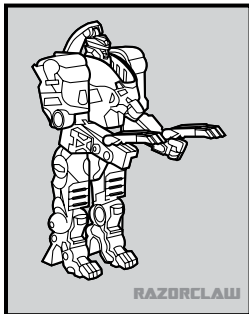

Reverse order of instructions to convert back into robots.



© 2008 Hasbro. All rights reserved.
TM & © denote U.S. trademarks.
Manufactured under license from Tomy Company, Ltd.

Some poses may require hand support.

P/N 6805280000

TRANSFORMERS.COM



Not suitable for children under 3 years because of small parts - choking hazard.